

Presentation

Part Number: WM 226.188

Medical Arm Dual Combo Lift Foldable and adjustable in height Rail 1200 mm, Weight supported balancing scale from 4 to 10 Kg

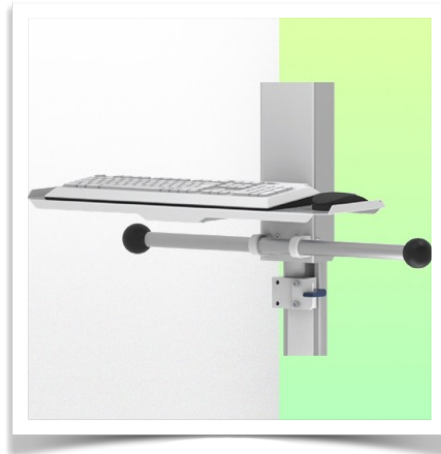
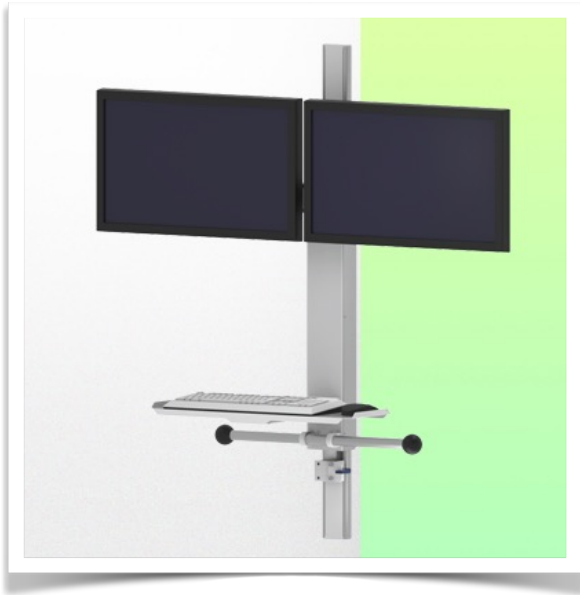

This Dual Combo lift arm has a 300mm automatic gas lift mechanism that allows for ideal positioning of the keyboard and two monitors regardless of the user's height. Its keyboard/mouse holder is retractable, foldable and magnetic, making it the ideal solution where space is at a premium. It is coated with an anti-microbial agent to ensure hygiene and cleanliness in every detail. These screen mounts are VESA 75/100mm mounting standard. The modern design has been specially developed for healthcare environments.

Technical specifications:

- * Integrated cable management
- * Foldable, retractable and magnetised 580 x 200 mm keyboard stand. This takes up only 100 mm of folded keyboard and 490 mm of retracted keyboard. It also allows the keyboard to be rotated 110° to the right and 110° to the left. Its ball-and-socket joint is ideal for saving space. The mounting heads comply with the VESA MIS-D 75 mm and 100 mm screen mounting standard
- * Screen tilt: 10° down and 15° up
- * It has a safety stop button for height adjustment, which allows the arm to remain in the selected position.
- * Equipped with a handle on the right and left side to allow for height adjustment of the system.
- * Maximum load of the system 4 - 10 Kg.
- * The horizontal rail for the two screens is 721mm and can accommodate two screens with a maximum weight of 8kg each.
- * Please check the width of your screens, if necessary contact our technical department for a longer dimension
- * Colour RAL 5013 cobalt blue and RAL 9016 traffic white
- * Warranty: 5 years

Technical specifications

Part Number: WM 226.188

Medical Arm Dual Combo Lift Foldable and adjustable in height Rail 1200 mm, Weight supported balancing scale from 4 to 10 Kg

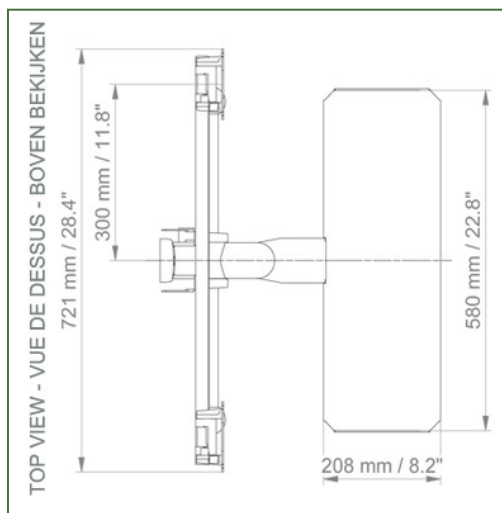
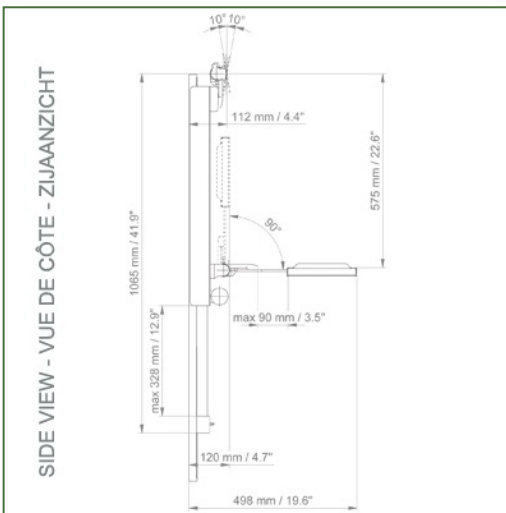

Monitor fitting: VESA 75/100 mm

Color: Decorative parts: RAL 5013 cobalt blue

Aluminium parts: RAL 9016 traffic white

Balance scale of this medical arm: 4 - 10 Kg

Product weight: 13 Kg **Maximum weight per screen:** 8 Kg

Height adjustment: parallel mechanism for a constant viewing angle

Safety: Has a safety stop button for height adjustment, which allows the medical arm to stay in the chosen position.

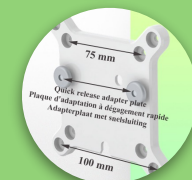
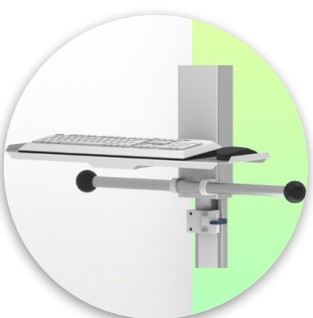

Visual

Part Number: WM 226.188

Medical Arm Dual Combo Lift Foldable and adjustable in height Rail 1200 mm, Weight supported balancing scale from 4 to 10 Kg

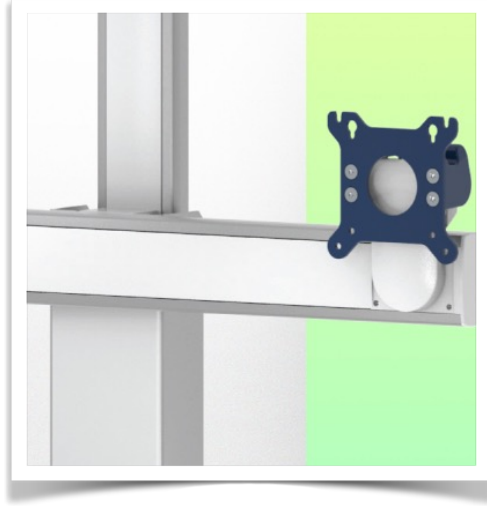
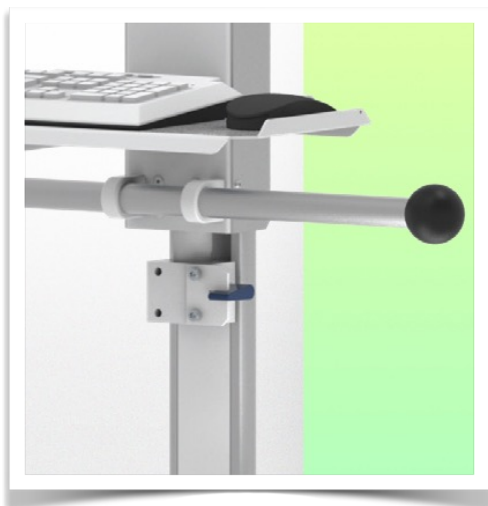

Technical drawing of this Combo Lift configuration

Part Number: WM 226.188

Medical Arm Dual Combo Lift Foldable and adjustable in height Rail 1200 mm, Weight supported balancing scale from 4 to 10 Kg

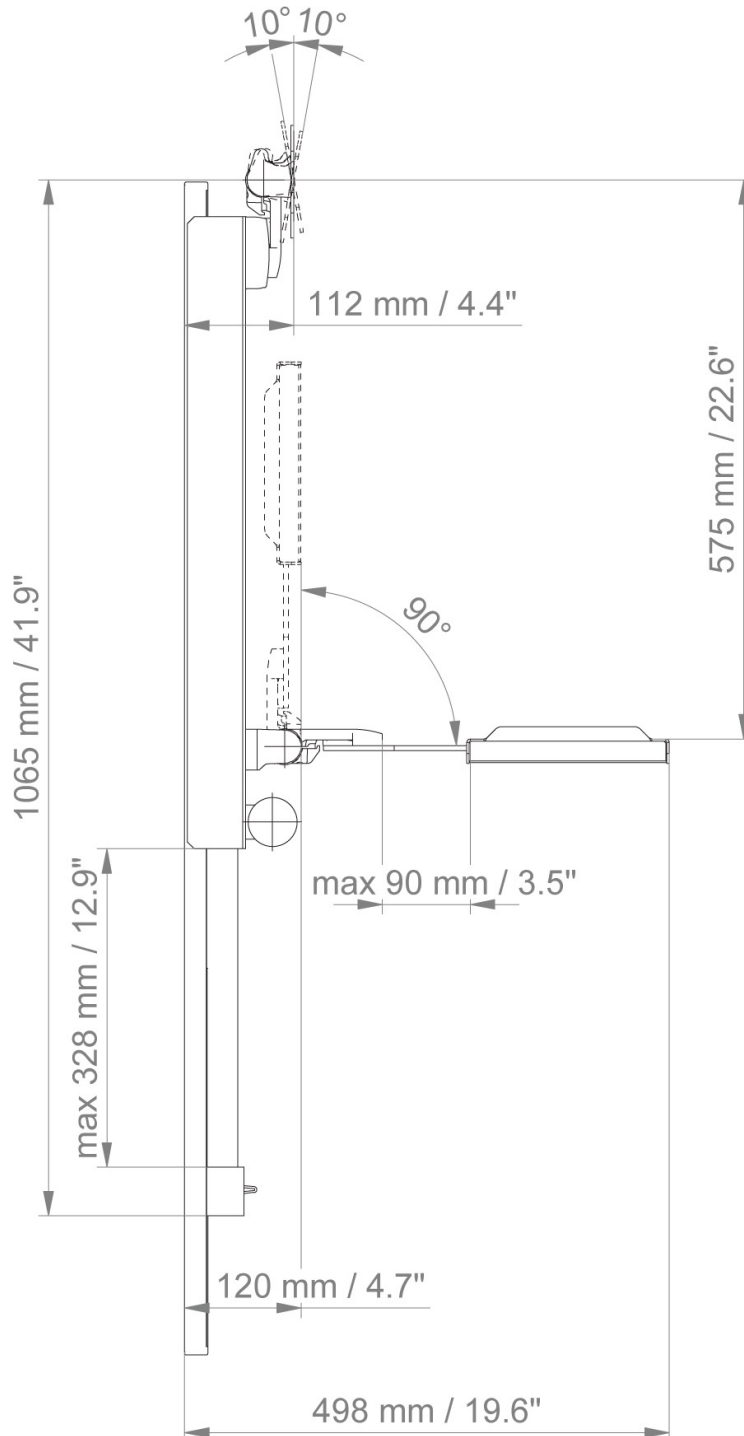

Technical drawing of this Combo Lift configuration

Part Number: WM 226.188

Medical Arm Dual Combo Lift Foldable and adjustable in height Rail 1200 mm, Weight supported balancing scale from 4 to 10 Kg

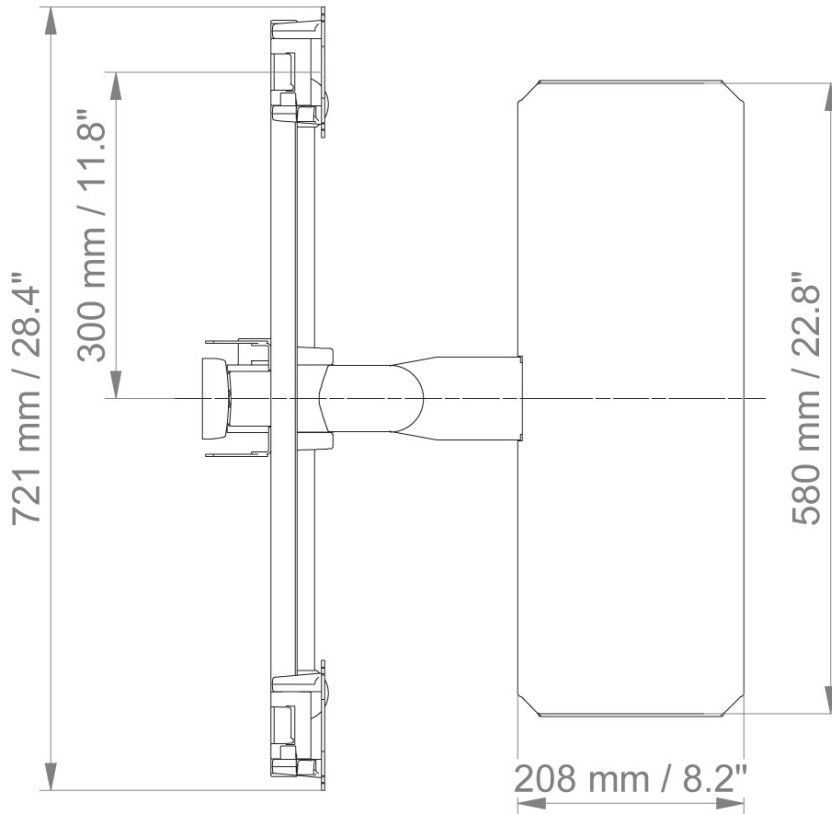

Product Highlights:

Height adjustable arms offer full cable integration and easy cleaning for infection control in all critical care areas of the clinical environment. Our 5-year warranty ensures reliable, trouble-free and maintenance-free operation. The swivel function at the point of attachment as well as the tilt and swivel function of the monitor adaptation offer optimal positioning of your device. The height-adjustable arm in its extended version is a two-part arm with a central pivot point between the two arm sections. All bottom mounted monitors have the safety feature of a 20° tilt stop.

